



# Educational Tour Report



**Submitted To - Dr.Pratibha Arya**

**Submitted By : Arudhi  
Purohit**

**Name - Arudhi Purohit**

**Class - B.S.C Final Year**



# EDUCATIONAL TOUR

Educational Tour is started from Talwari (college) to Almora on 14, March, 2024. This was 1 day trip.

In this tour all stream students are present B.A, B.Sc and M.A. In this tour teachers, college staff, also participate with us. In this tour we were total 38 students and 8 teachers.

For tour 2 buses were booked for students and teachers.

We all met in the market at 5:30 in <sup>the</sup> morning to go on tour. After we reach at market than teachers took our attendance and count total number of students. to check that is there any student is absent who give there noc for the tour.

After this we wait for 5-10 min for our buses and at 5:45 our buses also reach at the market (talwari). mannerly some students sit in 1 and rest in other and teacher also some in 1 bus and some teacher in other.

after this we start our journey happily, and enjoying the tour with all the friends in the bus.

After walking some distance we took a short washroom break. at petrol pump.





after the washroom break. At Kosi we stop for breakfast. At breakfast we eat also paratha and tea.

~~From~~ \* Now from Kosi Almora is only 5 km far. At Kosi where we were stop for breakfast, we did a little photoshoot till breakfast arrived.



Then after breakfast we left from there to Almora. Before almora we stopped at Manaskhand Science Centre (Almora). It has been some days since Manaskhand Science Centre opened.



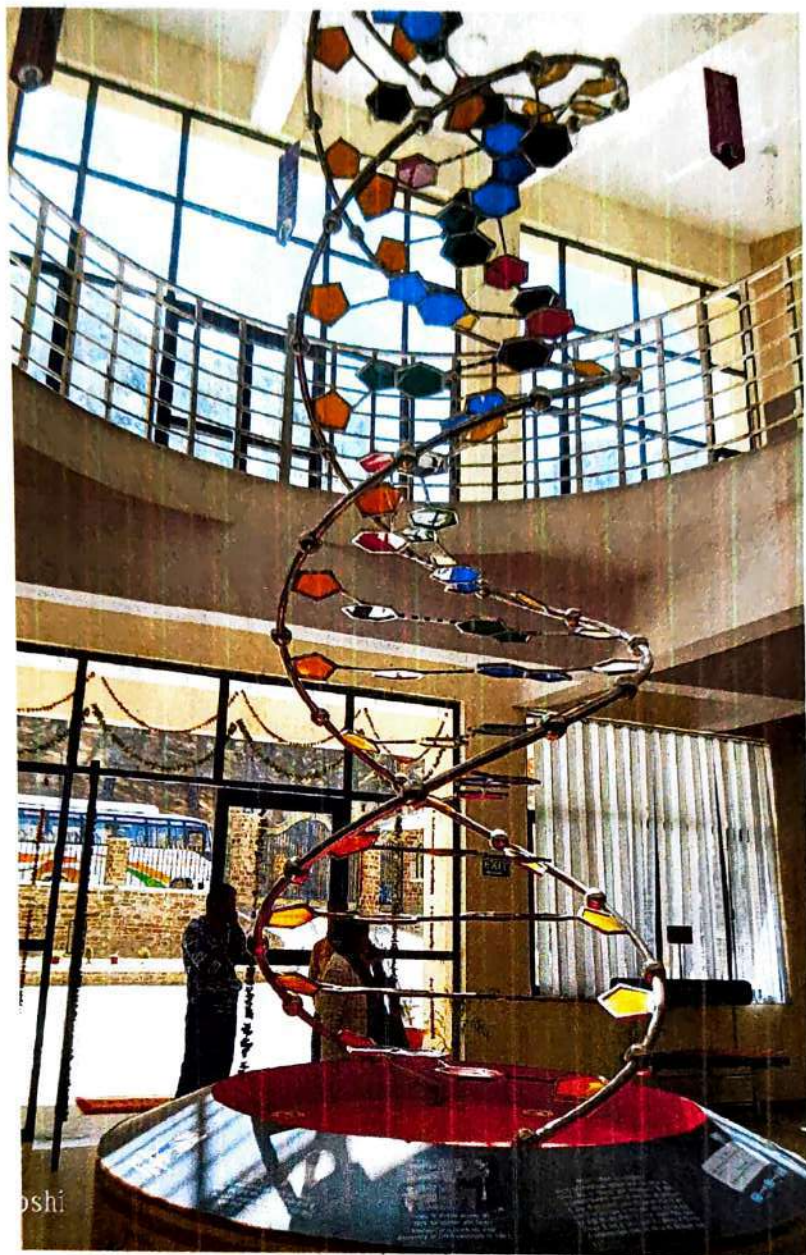

The first science park in Kumaon, the Manaskhand Science Centre in Almora, was virtually inaugurated by chief minister Pushkar Dhami on Sunday. The construction of this innovative park commenced in 2018.

C.M. Mr. Pushkar Singh Dhami highlighted the significance of the Manaskhand Science Centre in fostering a new interest in science among school children.





With the aim to develop interest of students and youth towards science and create a scientific orientation in them, the construction work for the Regional Science Centre, begun in Syalidhar village of Almora.

The centre is being established by the National Council of Science Museum, Kolkata and it will be supervised by the Uttarakhand State Council for Science and Technology.



Date \_\_\_\_\_

After reaching there we divided into 2 groups, because we were 40 students and we have less time to visit all the corners. and things were more to see and observe.  
↓ group went to the upper floor to watch and observe the magic of science with the centre staff.



And the second group started watching from the floor below with the staff there, with us our teacher also observe the things.  
In the down floor there was a planetarium (tara mandal).





Group wise we went to the planetarium to see the inside view or atmosphere it was so dark because only in dark we can see the stars. we were accompanied by staff there who gave us complete information about the tara mandal. after coming out from there (planetarium) we went upstairs to explore more. There we firstly visit to (नवप्रवर्तन केन्द्र).



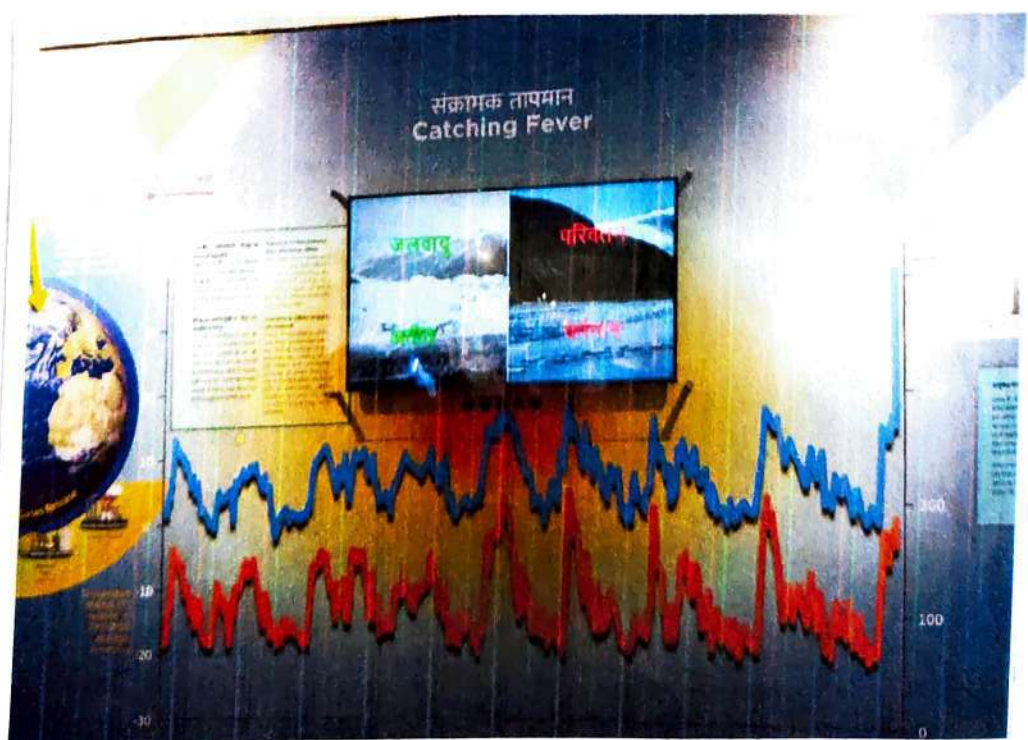



In "Navpravantan Kendra" we see very much things related to Chemistry, Physics, Biology. There are so many things done practically we read in our books. But some different thing which we see there was a 3D printing in which we did a practical to check how it work.

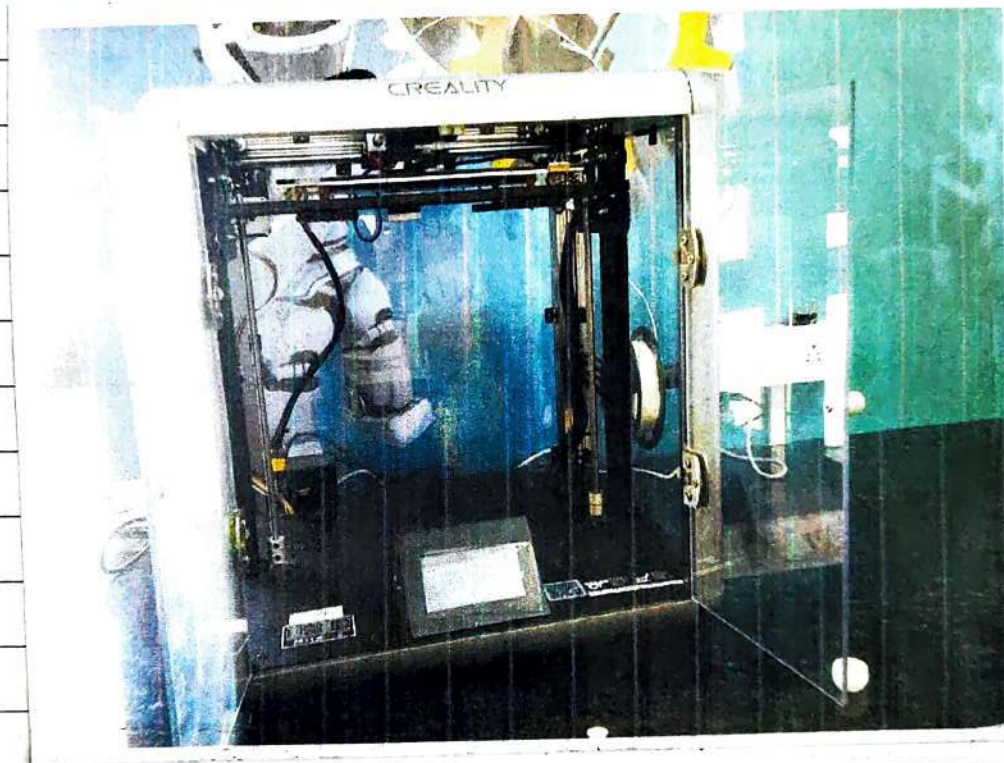

3D printing or additive manufacturing is the construction of a three-dimensional object from a CAD model or a digital 3D model. It can be done in a variety of processes in which material is deposited, joined or solidified



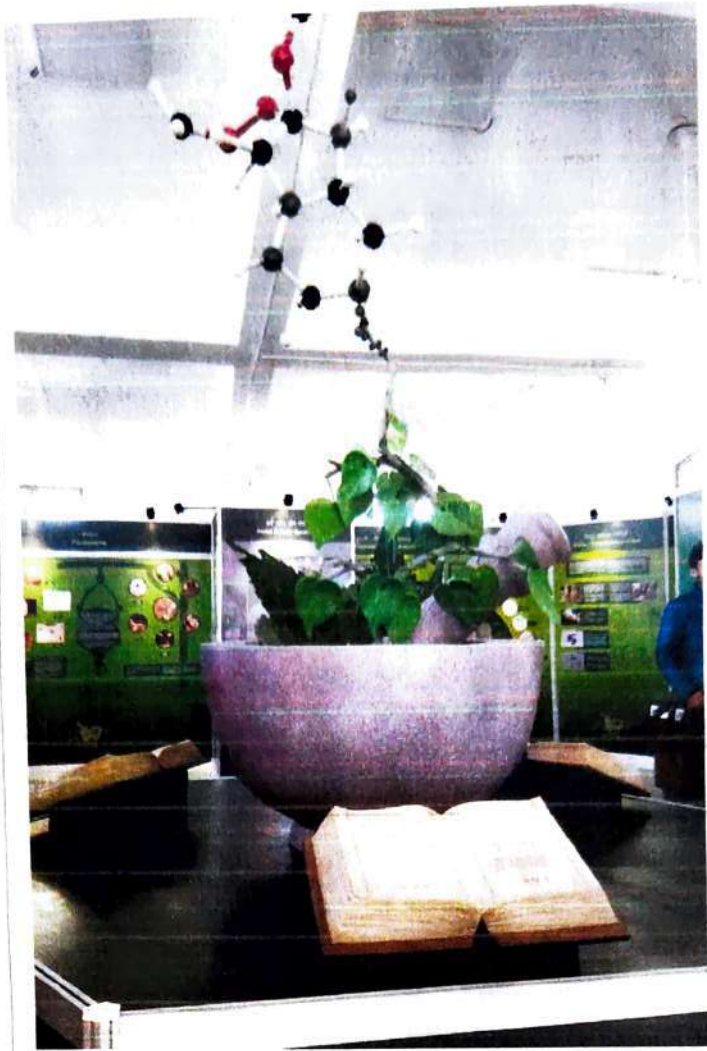

Under computer control, with the material being added together, typically layer by layer.

After that we went "Traditional Medicine पारंपरिक चिकित्सा", there we see so many ayurvedic techniques, which we were not using nowadays. There we learn so many ayurvedic uses. One centre staff explain us the whole information about Traditional Medicine room. There we see different different methods of Ayurvedic which were can use in daily life which are very helpful to us.







## हिमनदी (ग्लेशियर) का घटना Glacier Retreat

### क्यों? (Why?) का कारण है

- 1. ग्लेशियर का पिघलना एक धीरे-धीरे चलने वाला प्रक्रिया है जो हजारों सालों से चल रहा है।
- 2. ग्लेशियर का पिघलना एक धीरे-धीरे चलने वाला प्रक्रिया है जो हजारों सालों से चल रहा है।
- 3. ग्लेशियर का पिघलना एक धीरे-धीरे चलने वाला प्रक्रिया है जो हजारों सालों से चल रहा है।
- 4. ग्लेशियर का पिघलना एक धीरे-धीरे चलने वाला प्रक्रिया है जो हजारों सालों से चल रहा है।
- 5. ग्लेशियर का पिघलना एक धीरे-धीरे चलने वाला प्रक्रिया है जो हजारों सालों से चल रहा है।

### Why Does a Glacier Melt

- 1. Climate change is the primary cause of glacier retreat.
- 2. Warming of the atmosphere and oceans has led to a rise in sea level rise.
- 3. The retreat of glaciers is a result of the loss of ice mass.
- 4. The loss of ice mass is due to the melting of ice.
- 5. The melting of ice is due to the warming of the atmosphere and oceans.

joshi

## तथ्यों का पुनर्स्थापन, काल्पनिकता का त्याग Reinstate Facts, Retire Fictions





The full name of this institute is "ICAR-Vivekananda Parvatiya Krishi Anusandhan Sansthan" Almora and established / founded in the 1924 is a modern educational institution.

The main object of the institute is to provide quality education to enhance individual performance and elevate professional standards through innovative training programs in varied disciplines, research and extension activities.

With around 130 organisations from around 60 countries ICAR has a world-wide membership network, making ICAR a global membership network. ICAR is a Indian Council of Agricultural Research (ICAR) is an autonomous organisation under the Department of Agricultural Research & Education







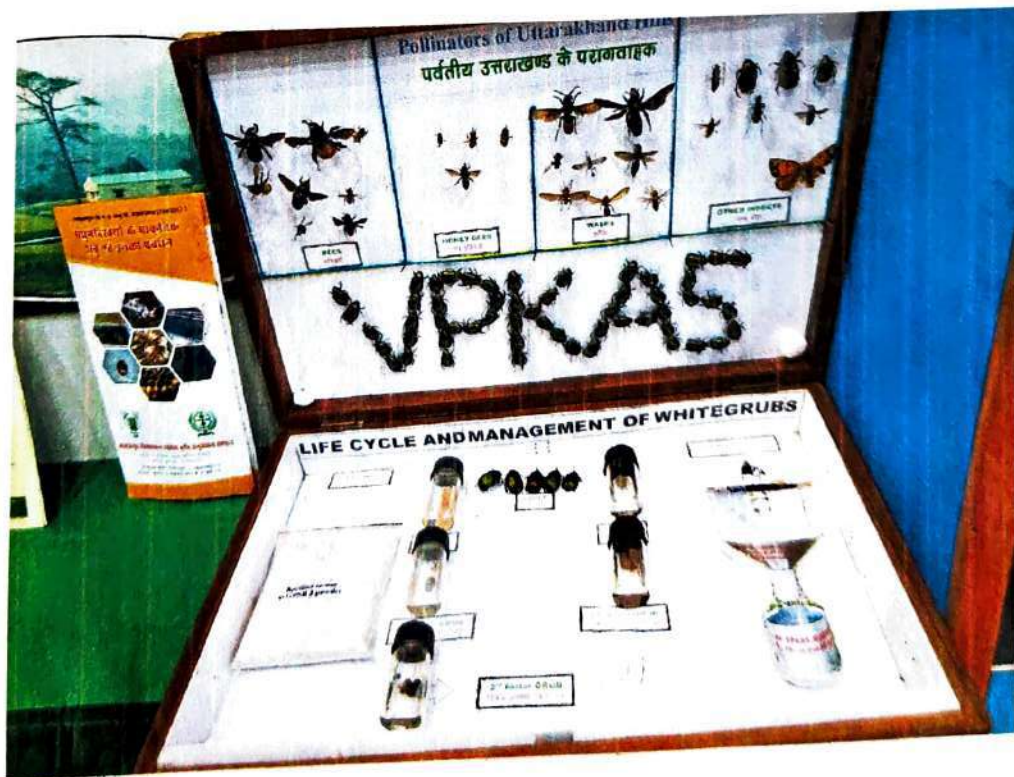





The G.B. Pant National Institute of Himalayan Environment is the focal agency of the Indian government to advance scientific knowledge about the Indian Himalayan Region, and to evolve integrated management strategies, demonstrate their efficacy for conservation of natural resources, and to ensure environmentally sound development in this region.

The Institute was established in August 1988, during the birth centenary year of Bharat Ratna Pt. Govind Ballabh Pant, as an autonomous Institute of the ministry of Environment, Forest and Climate change, Govt. of India,

which has been identified as a focal agency to advance scientific knowledge, to evolve integrated management strategies, demonstrate their efficacy for conservation of natural resources.







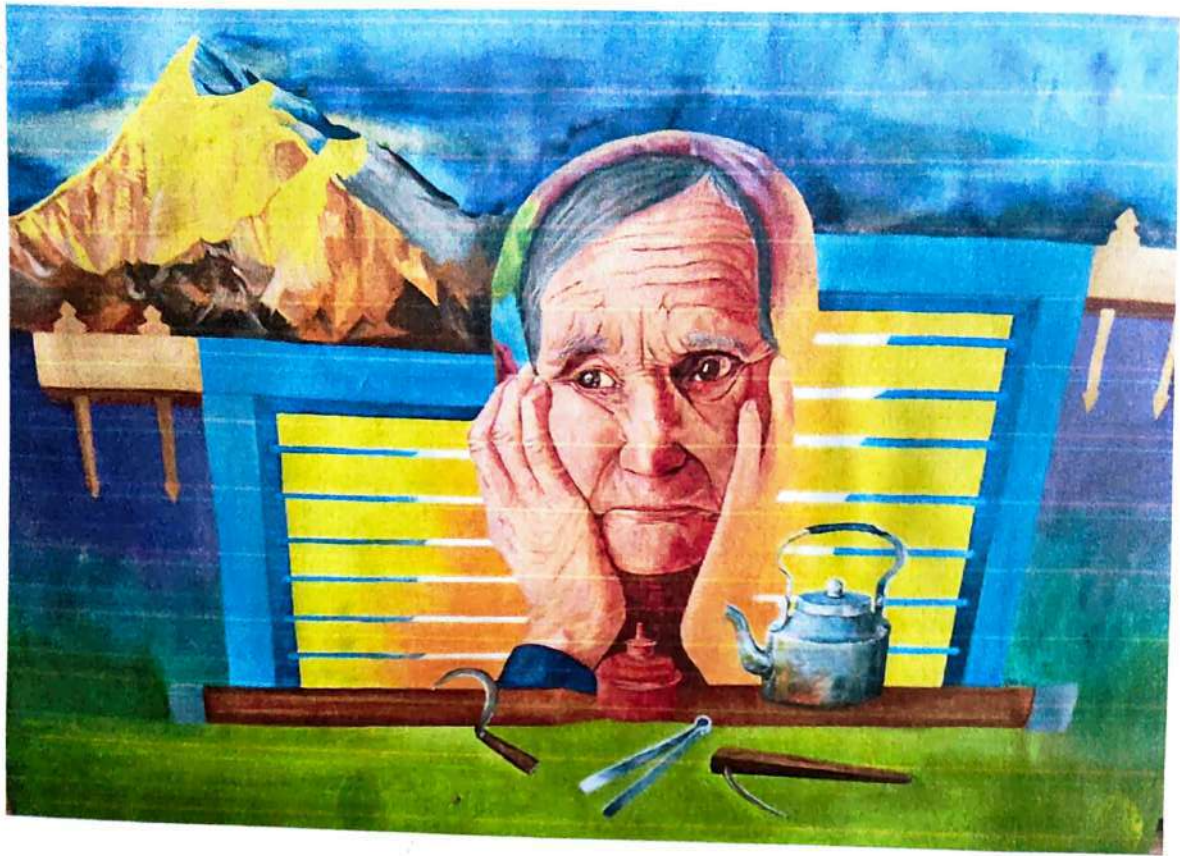

## CBC (Capacity Building Centre)

CBC is running by Mr. Kalyan Mankoti sir. He has a great personality. He is a government teacher of English. His story during Covid pandemic is very interesting and inspiring for all of us.

On Teacher's Day, he received the National Award for Teachers 2015 from the President, Shri Pranab Mukherjee.

For him, teaching is more than imparting knowledge. It is about inspiring change. Fearing learning loss at the onset of the pandemic, he moved from the comfort of Almorosa town to Chandli village. He ~~was~~<sup>also</sup> motivated his old students to teach in the school, even the villagers are





pitching in. His innovative teaching methods like teaching in natural surroundings has inspired many teachers in other districts to adapt his methods.

The current focus of Mankoti Sir is on three major areas - Art, Agri and Adventure. Lot of young kids or youth's have been given the opportunities here and we witnessed some amazing work (e.g - by ~~giving~~ provided employment to the the unemployed and the helpless students by their own hidden talent like painting, drawing). He also just getting started with a library on his own home at Almorah by managed to take a quick pic.

Teacher's Signature \_\_\_\_\_



after here, we came back to our way, but firstly we did lunch at . after having lunch we went to Katarmal sun temple. It is believed to be more than 800 years old and is of great historical importance. The temple is well-known for its intricate sculptures. Temple is constructed by Katyuri kings in the 9<sup>th</sup> century CE. It is situated at a distance of 19 kms of Almora.





**Government Degree College Talwari-Tharali**



# **STUDY TOUR REPORT**

## **2023-24**

**A**  
**Tour to**  
**Cultural Capital of Kumaon & Heart of Kumaon**  
**in**  
**Uttarakhand**

**Department**

**Botany Education Tour**

**Submitted by:-**  
**Prenea Sati**  
**(B.sc.- 2<sup>nd</sup> Sem )**



# Introduction →

Educational tour means the tour of giving informative knowledge or ideas about any place, or the things. Recently our collage organize a educational tour, which is very useful for students and that was very informative for us. The students get a chance to see and learn thing in a practical manner. This types of learning cannot be achieved through books. The tour make collage curriculam. Interesting and informative and a group. Travelling provides us a different type of knowledge.

# Objectives →

Organisation of educational tourism. Is to achive desirable objective.  
To in-culate the positive of students toward tourism.



- To inculcate the positive of students to word tourism.
- To organize the knowledge systematically through preception
- To develop the observation skill imagination skill exploratory skill etc. among students.
- To develop the feeling of co-operation and empathy among students.
- To provide real world knowledge of society and historical heritage of the india.

# Planing →

Planing is an important part of anything which has to be started for some purpose to be Beneficial.

Planing was done before the commencement of our journey to Almore.

Maney was collected from the student before hand

Responsibilities were given & assigned to free students for carrying out the purpose



smoothly.

Students were given free ship instruction schedule was given to students, so that they may become mentally prepared. Destination, means institutes are where we go are pre-decide.

Transport (four buses) were pre-booked by faculty.



# Mamankhand Science

## Centre, Almora

This institute is the first destination of our tour. The first stop in Almora, the mamankhand science centre in Almora, was virtually inaugurated by chief minister phulkar singh chahal on sunday. The commenced in 2018. General director, durgesh part. Uttarakhand Science and technology council "He said" The centre will greatly enhance science tourism in the region. Inside the institute we saw DNA double helix model.

And we a constellation a beautiful time when we watch our own eyes it was like a practical and when climate change. How melt down and the coral Reef - The underwater forests eating the earth process.

How had exactly is it going to get? Our earth is likely to continue to warm over this century and beyond. Globe





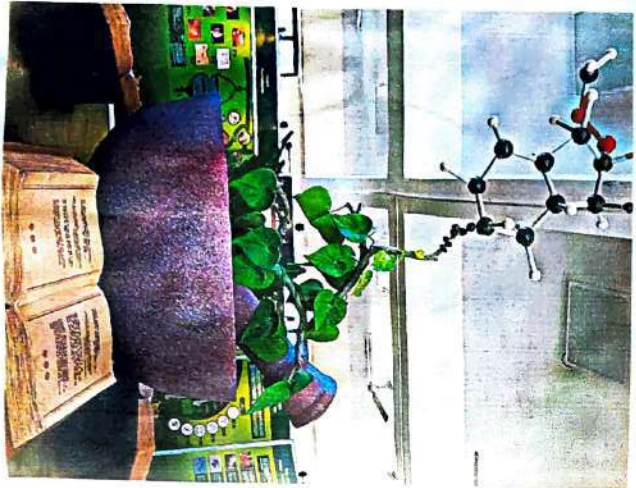

temperatures have already risen by about the pre-industrial period of 1850-1900. Fresh average temp. could be between 1.1°C to 5.4°C warmer in 2100 then it is today

Station No.

Page

Date



# Kalyan Markoti Department

Our next destination of tour is in Kalyan Markoti ji department and he showed us his library and department. There are many things like some beautiful paintings made by the handicapped children and they said - he calls himself an activist. An activist who wants to children to live. Their dream while people do things to save their jobs, he fights and bushes for change for good.

"The weakest of all are you but the stronger ones are against you"

And he said - Migration is a big issue in the Rahaf region. But he had different perspective on this. As the COVID-19 pandemic weeks have on the world, stories of frontline workers who have on the gone above and beyond to fight hope in this time of crisis come to light. He is also village in uttrakhand Raagskhar and He used 35km from almora town to reach Tunc.





## G.B Pant National Institute of Himalayan Environment (NIHE)

Then we go G.B Institute of Himalayan Environment.

The G.B Pant national Institute of H.E. is the focal agency of the Indian, Himalayan region. and it is involved in integrated management. The institute has decentralized at Kosi, Almora.

The institute has decentralized at Kosi-almora. At the headquarters, the research and development activities of the institute are organized among four thematic centre.

This institute was established in august 1988. during the birth centenary year of bharat rana. It giving ballabh pant as an autonomous institute of the ministry of environment, forest and climate change.

The centre for land, water resource management. The centre for socioeconomic and development the centre for biodiversity.

And in this institute we have an amazing experience and knowledge we get.

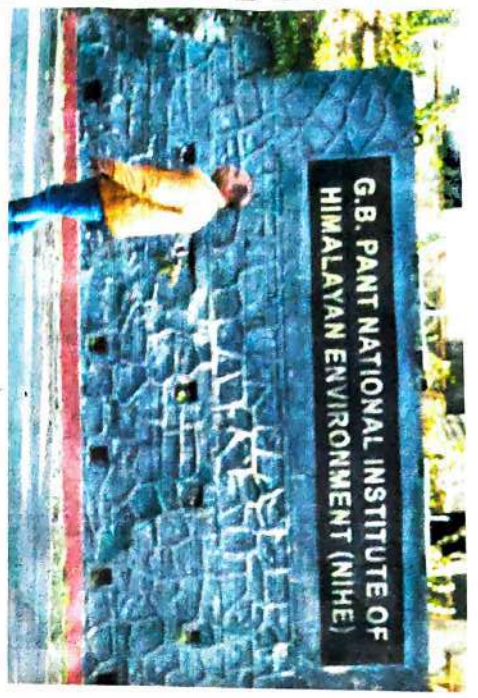



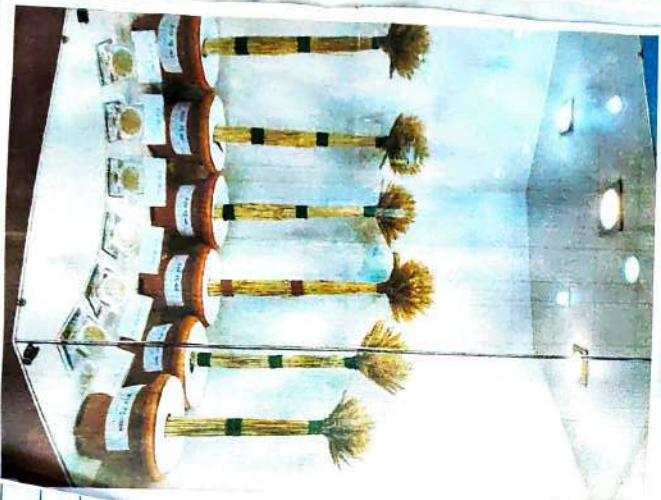

Sl. No. \_\_\_\_\_  
Date \_\_\_\_\_

## ICAR-Vivekananda Institute of Hill Agriculture, Hawalbagh, Almora

And we search in this institute this institute was established at kolkata by pedana bhawan late prof. Bashi Sen in july 1924 and named it was vivekananda laboratory. The laboratory was permanently shifted to Almora in 1936 and was being run on donations and on october 1, 1974, ICR took it over and renamed as vivekananda Purvaha, kishor Anuson -dhan sansthan. Crop coefficient (CC) represents the actual crop growth of the crop. It plays an important role in water management. The crop is play important role in water stages of growth. Reference evapotranspiration (ET<sub>0</sub>) is a crucial parameter in hydrology that is used to estimate the amount of water. Water security of hilly region has been increasing due to unprecedented population growth, rapid urbanization, industrialization, various anthropogenic activities.

Rainfall is important for crops.



# Surya Kuny Institute

This Institute was established in 1992. Initially the area was under highly degraded grazing land interspersed with pine trees and shrubs. Subsequently has attached the forest elements especially the tree.

Birds, butterflies and bees to flourish the aesthetic and Biodiversity value of the centre. This institute celebrate havela festival in order to spread awareness about environment in the society and when we go so they told us how they test the plants and then research is done on shade plants.

They told us to test the plant are many processes. and this is new for us. and I was quite happy to know the thing students do many things to save our environment.

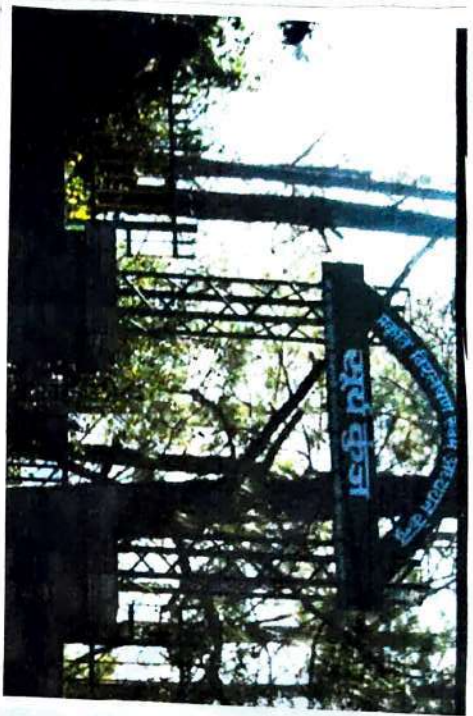



MOVEMENT PLAN OF THE SUN TEMPLE, KATARMAL, DISTRICT, ALMORA (UTTARAKHAND)

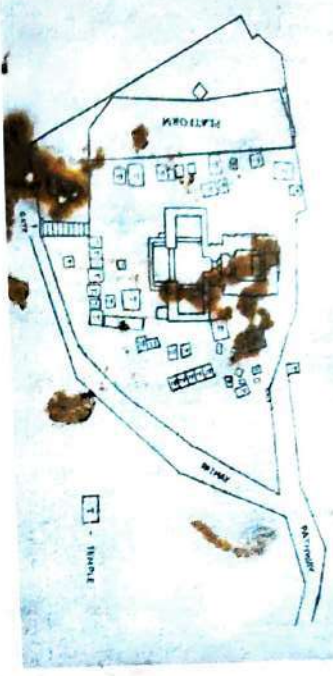

Serial No. \_\_\_\_\_

Page \_\_\_\_\_  
Date \_\_\_\_\_

# Katarmal, Sun Temple

The Katarmal Surya Temple is the last halt of our tour. and that was a blessing full stage for us. The Katarmal Surya Temple is a 9th century temple built by Kalarmalla, a Kashmiri exhibiting the ancient architectural style of the ancient artisans. This Hindu temple is perched on an elevation of 2.916 meters above sea level and is situated at a distance of 19 kms from Almora.

It is popular for historical monuments of national importance.

The Surya Mandir is also known as Badachitya temple. This temple once boasted the intricate designed carved on the wooden doors and panels of the temple. Making it second most beautiful shrine in India. However after the theft of a 10th century idol. The carved wooden doors and panels were transported to the National Museum Delhi. when the first sun rays fall on Katarmal Surya Temple it enlighten with ancient idol of a sun god called Varaditya. I felt very



happy and blessing about visiting the our temple, It was very beautiful and memorable journey for me.

**Purpose** — The purpose of the trip is non-experimental research or observation for education students with experience outside their everyday activities. To appreciate culture and arts. In addition students learn to communicate oral written, and technological information reflecting professional skills.

## **Conclusion** →

Educational tour of Almora was an amazing experience for all of us. I especially enjoyed it a lot we got an opportunity to know about institutions, love for nature Temple understand the importance of nature



We also gained a knowledge of culture of the area. The advantage was that we all friends are to get closer to one another. Learn the qualities of co-ordinate with each-other.

The memories in that small time created have become for a treasure of lifetime, and our teachers with us. They are also enjoying the game.

And very knowledgeable informative for us. So, overall it was awesome unforga-  
-table for all of us.



10/10/25/04/24

राजकीय स्नातकोत्तर  
महाविद्यालय तलवाडी

नाम => अनीता शवत

कक्षा => M.A IV Sem

शै.नं. => 105229465006

विषय => प्रयोजनमूलक  
हिन्दी और मीडिया  
लेखन

अध्यापिका => डॉ. पुष्पारानी

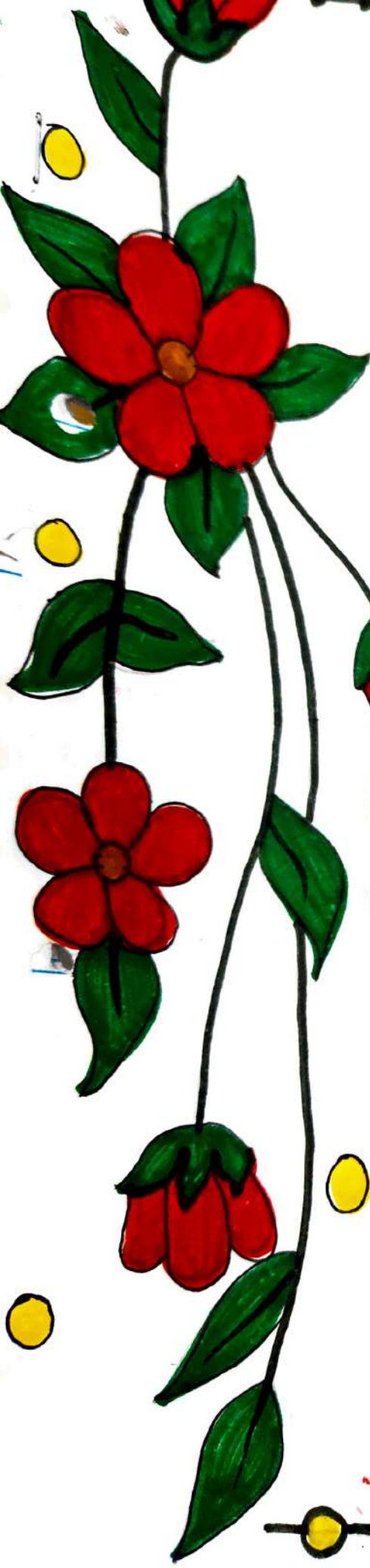



09/10/24 29/04/24

राजकीय महाविद्यालय तलवाडी-चमोली

आंतरिक मूल्यांकन परीक्षा 2024

विषय- हिन्दी

प्रश्न पत्र- जनपदीय भाषा साहित्य  
(गढवाली भाषा साहित्य)

नाम- सन्तोषी

पिता- श्री हरिन्द्र सिंह

कक्षा- M.A.IV सेमेस्टर

अध्यापिका- डॉ० पुष्पा शर्मा



09/10/24

# महाविद्यालय

तलवाडी

राजकीय

असाइमेंट प्रदत्त कार्य.

सन् → 2024

नाम → लीला

कुटा → M.A.IV Sem.

बो.न →

पिता का नाम → श्री लीला राम

कुटा अध्यापिका → डॉ. पुष्पा रानी.

विषय → जनपदीय भाषा साहित्य.

( हिन्दी )

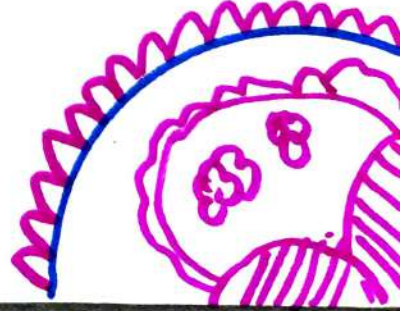
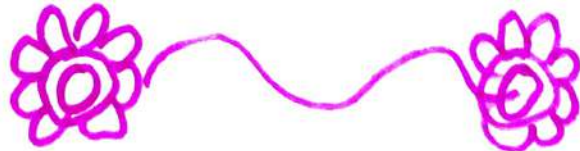
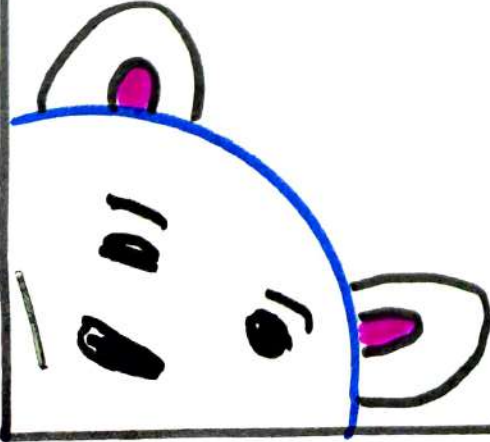





05/10/24 29/04/24

राजकीय स्नातकोत्तर  
महाविद्यालय तलवाडी

नाम - अनीता शवत

कक्षा - M.A IV सेमेस्टर

रौं नं - 105229465006

विषय - हिन्दी

प्रश्नपत्र - जनपदीय भाषा साहित्य

पिता - श्री सुरेन्द्र सिंह शवत

अध्यापिका - डॉ. पुष्पा रानी